

FOR APPROVAL



DRAWING NO: AR-01a-R3	DATE 02-06-16
DRAWN BY ROHIT	SCALE NTS



406, "kalvanna" Panchvati Ahmedabad - 380006,
Tele: 079 2640 1399 fax : 079 2656 9476
auctors@dataone.com
auctors@gmail.com

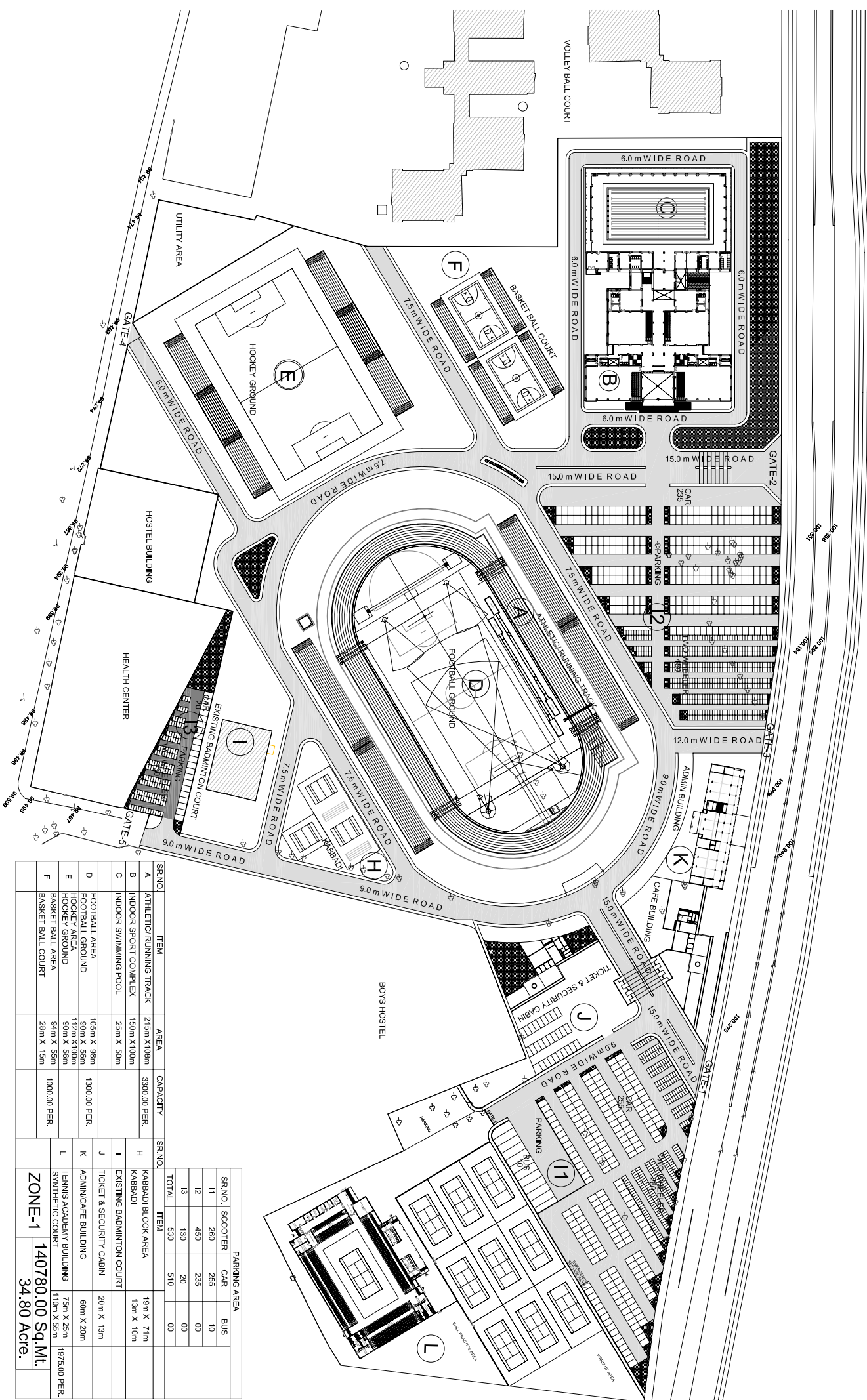

SR.NO.	ITEM	AREA	CAPACITY	SR.NO.	ITEM		
A	ATHLETIC/ RUNNING TRACK	215m X108m	3300.00 PER.	H	KRABADI BLOCK AREA	19m X 77m	
B	INDOOR SPORT COMPLEX	150m X100m		I	KRABADI	13m X 10m	
C	INDOOR SWIMMING POOL	25m X 50m		J	EXISTING RADMITTUN COURT		
D	FOOTBALL GROUND	105m X 98m	1300.00 PER.	K	TICKET & SECURITY CABIN	20m X 13m	
E	HOCKEY AREA	90m X 56m		L	ADMIN/CAFE BUILDING	60m X 20m	
F	BASKET BALL AREA	112m X100m			TENNIS ACADEMY BUILDING	75m X 25m	
	BASKET BALL COURT	94m X 56m	1000.00 PER.		SYNTHETIC COURT	110m X 55m	1975.00 PER
		28m X 15m			ZONE-1	140780.00 Sq.Mt.	
						34.80 Acre.	

PARKING AREA			
SR.NO.	SCOOTER	CAR	BUS
11	260	255	10
12	450	235	00
13	130	20	00
TOTAL	530	510	00